



PUFFCO

PEAK PRO 3DXL

ENGLISH | ESPAÑOL | FRANÇAIS
NEDERLANDS | DEUTSCH | PORTUGUÊS

WHAT'S INSIDE [01]

HOW TO USE [02]

PUFFCO CONNECT APP [05]

HEAT SETTINGS [06]

CLEANING [07]

TROUBLESHOOTING [09]

TIPS & TRICKS [10]

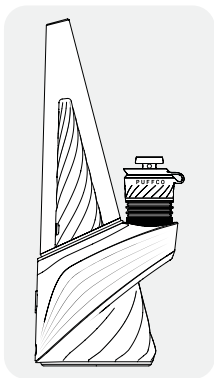

What's New



3DXL Chamber



XL Joystick Cap

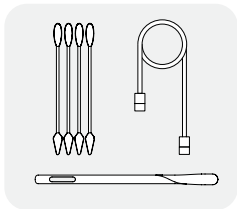

What's Inside

- 3DXL Chamber
- XL Joystick Cap
- Peak Pro Glass 2.0
- Peak Pro Base
- Loading Tool
- Cotton Swabs
- USB-C Cable

How To Use

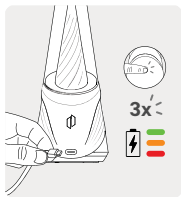

Fully charge the device before first use. The lights will glow indicating the battery level:

Green (Full)
Orange (Half)
Red (Low)

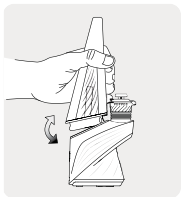

To remove glass, grasp the base and gently pull glass towards you. To reattach, align inlet hole with chamber and gently press glass into base.

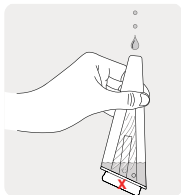

Always remove glass top before filling. Through the mouthpiece, fill with water to just above the perc slots.

X - Overfilling can result in water in lower section. Empty before usage.

How To Use

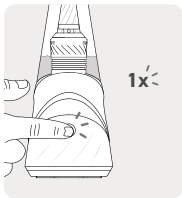

To turn the Peak Pro on/off, press & hold the button for 3 seconds.

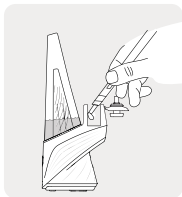

Use the loading tool to place extract on the bottom surface of the 3DXL Chamber.

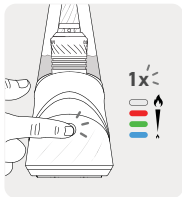

Single-click button to toggle through each heat setting.

White (Peak)
Red (High)
Green (Med)
Blue (Low)

How To Use

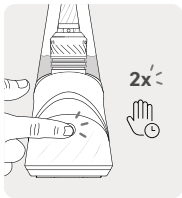

Double-click to initiate heat cycle, press & hold to cancel. Pulsing light indicates device is heating up.



Device will flash & vibrate twice when ready. For best results, inhale gently while rotating the XL Joystick.



Clean 3DXL Chamber after each use with a cotton swab. Wipe gently in a circular motion while chamber is warm.

Puffco Connect App

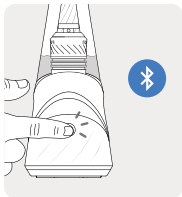

Hold the button for 6 seconds to initiate pairing mode. Pulsing blue lights indicate your device is ready to pair.



Visit [Puffco.com/app-experience](https://puffco.com/app-experience) to learn more.

Ready Mode

Ready Mode automatically initiates your selected heat cycle when you lift your Peak Pro from the Peak Pro Power Dock. Once your Peak Pro is paired with the Puffco Connect app, enable Ready Mode in the app settings.

Peak Pro Power Dock required.

Vapor Control Mode

Standard, High, Max — and XL. Vapor Control is a Puffco Connect app feature that allows you to customize your cloud size, independent of temperature. All Puffco Connect users with a 3D Chamber have access to the first three levels, but XL is only unlocked when a 3DXL Chamber is connected to your Peak Pro.

To activate: select the heat profile you want to edit, adjust the slider to your preferred level, and hold onto your lungs.

Choose a Setting

Each heat setting offers a different experience. We suggest experimenting to find which settings work best for you and your consumption preferences.

You can also experiment further with other interchangeable glass tops available for the Peak Pro.



Peak [Most Vapor] - 575°F

Delivering the most vapor and strength with less flavor.



High [Strong Vapor] - 530°F

Higher vapor production while maintaining flavor quality.



Med [Balanced Flavor] - 510°F

The best of both worlds. Balanced flavor and vapor.



Low [High Flavor] - 490°F

Best for delicate extracts. Optimal flavor, least vapor.

Tip: You can customize your heat settings down to the degree in the Puffco Connect app.

3DXL Chamber



Remove the XL Joystick with Jacket & Tether, then unscrew the 3DXL Chamber from base.

Use a cotton swab to gently remove any residue with 90%+ isopropyl alcohol.

Submerge the chamber in 90%+ isopropyl alcohol for 20 minutes. Air-dry completely before reattaching.

DO NOT rinse with water.



Allow chamber to cool completely before handling.



Isopropyl alcohol is highly flammable; allow chamber to air-dry completely before reattaching.

Glass

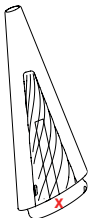

Carefully remove glass from base.

Once removed, submerge glass in 90%+ isopropyl alcohol for 20 minutes.

After soaking, thoroughly rinse glass with water and let air-dry completely before reattaching to base.

X Avoid allowing water into lower section.

Base

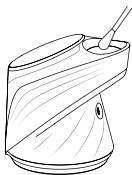

Remove glass and chamber from base.

Use a cotton swab soaked in 90%+ isopropyl alcohol to gently clean the connection points and air path between the chamber and glass.

Allow to air-dry completely before reattaching components.

DO NOT rinse or submerge in liquid.



Visit [Puffco.com/support](https://puffco.com/support)
for how-to videos and helpful tips.

Error Codes

No chamber (white white white white)

Remove and reinsert chamber.

Chamber error (red white red white)

Remove and clean chamber before reinserting.

Device overheating (red for 5 seconds)

Allow device to cool before using.

Low battery (red red red)

Ensure device is fully charged before using.

General Warnings

Do not overfill the chamber.

Do not blow or exhale hard into the glass. This will force water into the base.

Do not store device with water in the glass.

Strong inhales may cause spillage and damage to your chamber.

Do not charge or operate in temperatures beyond 32°F - 100°F

Use only with the provided USB-C cable.

Keep away from moisture and high humidity.

Store in a cool dark place when not in use.

Chamber becomes hot while in use; use caution when handling.

Boost Mode

Boost Mode increases the time and temperature of your hit. To activate, double-click to initiate heat cycle, then double-click again once desired temperature is reached. Boost Mode increases heat cycle duration by 15 seconds & temperature by 18°F.

Intensity Mode

Click 5 times to initiate a heat cycle with added intensity. This mode is specially designed for dry dabs, no water.

Stealth Mode

Click the button 4 times rapidly to turn Stealth Mode on/off. This disables the lights on your device for greater discretion.



**NEED HELP?
CONTACT US!**



Please do not return your Peak Pro to the store.
Keep your proof of purchase.

@Puffco

IEC Compliance

This appliance is not intended for use by persons (including children) with reduced physical, sensory, or mental capabilities, or lack of experience and knowledge, unless they have been given supervision or instruction concerning use of the appliance by a person responsible for their safety.

Children should be supervised to ensure that they do not play with the appliance.

This appliance must only be supplied at safety extra low voltage corresponding to the marking on the appliance.

WARNING: Use only an external supply with the following specifications: <5V> <2A>

The normal temperature range for charging the battery:
32°F – 100°F

The battery type: Rechargeable Li-ion Battery

Dispose of batteries according to your local environmental laws and guidelines.

The lithium-ion battery in the device should be serviced or recycled by an authorized service provider and disposed of separately from household waste.

Do not handle a damaged or leaking battery. Do not let leaking battery fluid come in contact with your eyes, skin, or clothing.

Do not expose the device or battery to excessive temperatures.

Be aware of the risk of terminals of the battery-operated device or battery being short circuited by metal objects.

This appliance contains batteries that are non-replaceable. When the battery is at end of life, the appliance shall be properly disposed of.